

HEIGHT CONTROL COMPRESSOR ASSY REPLACEMENT

2501B-01

HINT:

COMPONENTS: See page 25-8

1. REMOVE REAR DISC WHEEL
2. REMOVE QUARTER PANEL MUDGUARD SUB-ASSY REAR LH
3. REMOVE REAR BUMPER (See page 76-6)
4. REMOVE FUEL TANK FILLER PIPE PROTECTOR
 - (a) Remove the 4 clips and the fuel tank filler pipe protector.
5. REMOVE SPARE DISC WHEEL
6. REMOVE HEIGHT CONTROL COMPRESSOR COVER
 - (a) Remove the 3 clips and the height control compressor cover.
7. REMOVE HEIGHT CONTROL FILTER
 - (a) Disconnect the 2 clips and the 2 hoses.
 - (b) Remove the 2 bolts and the height control filter.

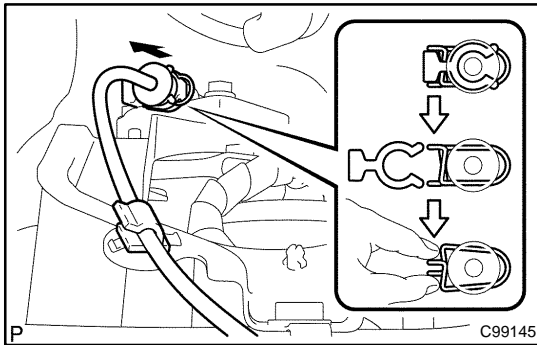

8. DISCONNECT HEIGHT CONTROL TUBE NO.2

- (a) Remove the holder.
- (b) Spread the clip and slowly pull the height control tube No.2 straight out.

NOTICE:

Do not remove the clip from the union except when replacing it.

- (c) Remove the 2 O-rings.

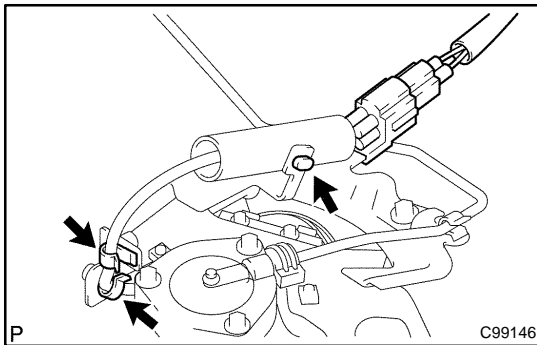

9. REMOVE HEIGHT CONTROL COMPRESSOR ASSY

- (a) Disconnect the connector.
- (b) Remove the 3 clamps.

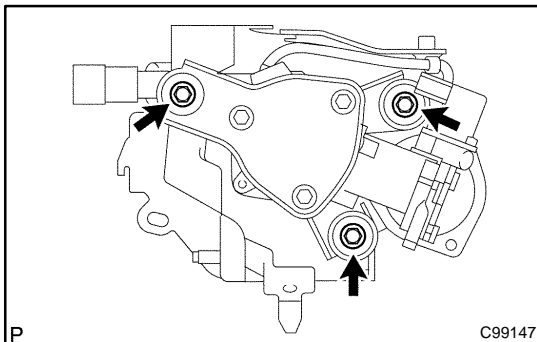

- (c) Remove the 3 bolts.
- (d) Disconnect the clip and remove the No.1 hose.

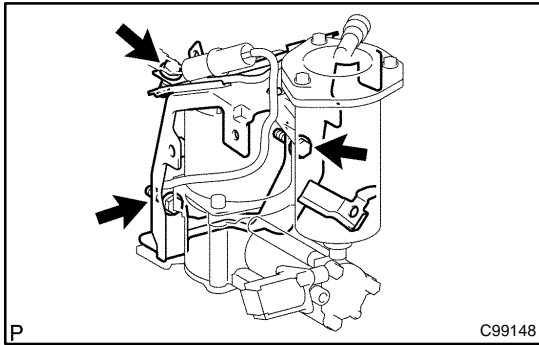

- (e) Remove the 3 bolts, the height control compressor and the dryer with the bracket.
- (f) Remove the bolt, the dryer and the O-ring.
- (g) Remove the 3 bushings from the height control compressor assy.

10. INSTALL HEIGHT CONTROL COMPRESSOR ASSY

- (a) Install the 3 bushings to the height control compressor assy.
- (b) Install the bolt, the dryer and the new O-ring.
Torque: 6.4 N·m (65 kgf·cm, 57 in·lbf)
- (c) Assemble the height control compressor, the dryer and the bracket as a unit to the vehicle, and tighten the 3 bolts to fix the bracket to the frame.
Torque: 29 N·m (300 kgf·cm, 21 ft·lbf)
- (d) Install the height control compressor assy to the bracket with the 3 bolts.
Torque: 5.9 N·m (60 kgf·cm, 52 in·lbf)
- (e) Install the 3 clamps.
- (f) Connect the connector.
- (g) Connect the No.1 hose with a new clip.

11. CONNECT HEIGHT CONTROL TUBE NO.2

- (a) Coat 2 new O-rings with MP grease.
- (b) Push the height control tube No.2 in straight to connect it until the clip makes "click" sound.

NOTICE:

Do not get scratches or foreign particles on the O-ring, O-ring seal and flare section.

- (c) Install the holder.

12. INSTALL HEIGHT CONTROL FILTER

- (a) Install the height control filter with the new 2 bolts.
Torque: 6.4 N·m (65 kgf·cm, 57 in·lbf)

- (b) Connect 2 new clips and 2 hoses.

13. INSTALL HEIGHT CONTROL COMPRESSOR COVER

- (a) Install the height control compressor cover with 3 new clips.

14. INSPECT AIR LEAK (See page 25-3)

15. INSTALL SPARE DISC WHEEL

16. INSTALL FUEL TANK FILLER PIPE PROTECTOR

- (a) Install the fuel tank filler pipe protector with the 4 clips.

17. INSTALL REAR BUMPER (See page 76-6)

18. INSTALL QUARTER PANEL MUDGUARD SUB-ASSY REAR LH

19. INSTALL REAR DISC WHEEL

Torque: 112 N·m (1,140 kgf·cm, 83 ft·lbf)